

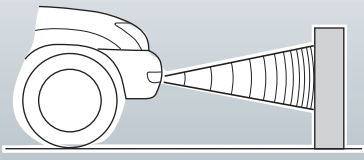

# PARK MASTER FRONT F394



Cod. 06DE3787D date 11/2013

Cobra Automotive Technologies  
via Astico 41 - 21100 VARESE - ITALY  
www.cobra-at.com

**1**

**2**

> 04/2014

**3**

PRIMER → SPRAY PAINT → GLOSS

MAX. 70 °C

**4 Typical Installation**

200-540 mm L1  
400-740 mm L2  
200-540 mm L3

400+550 mm

T1 + T4

**5**

**6**

**7**

**8**

**AV0091**

Ø 17 mm

9a

9

9b

**AV0090**

T1 + T4

**10**

**11**

**12**

F

4 3 2 1



13

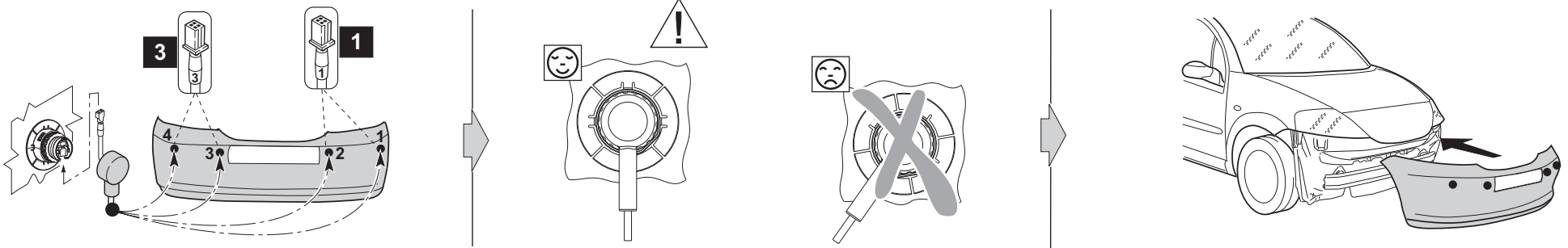

14

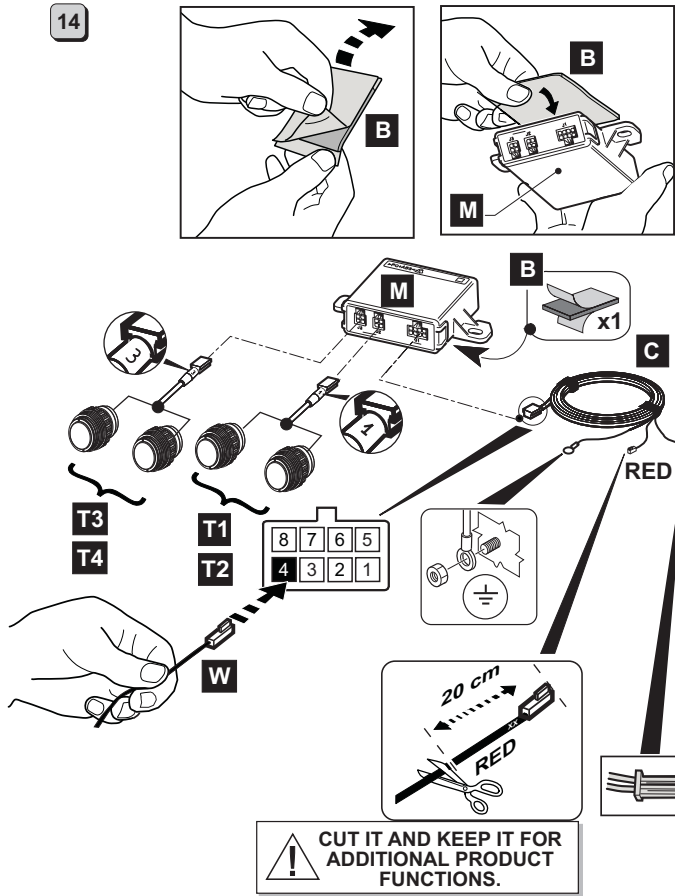

15

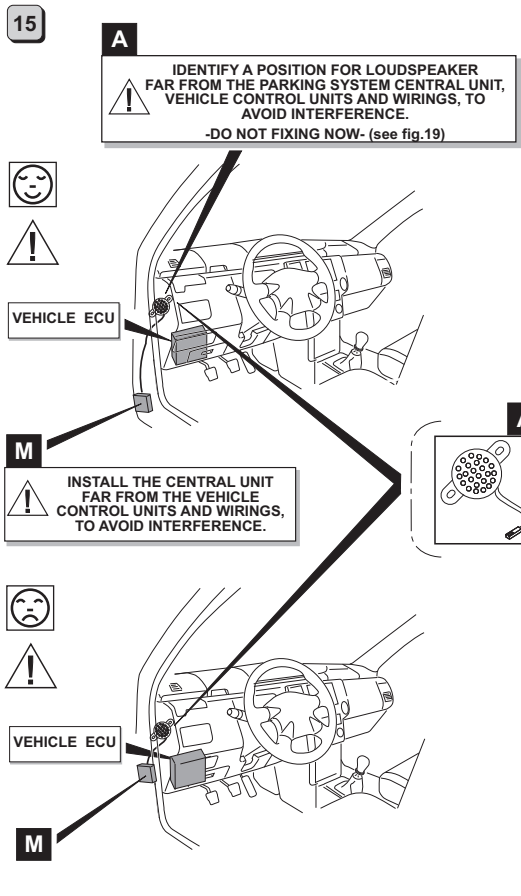

16

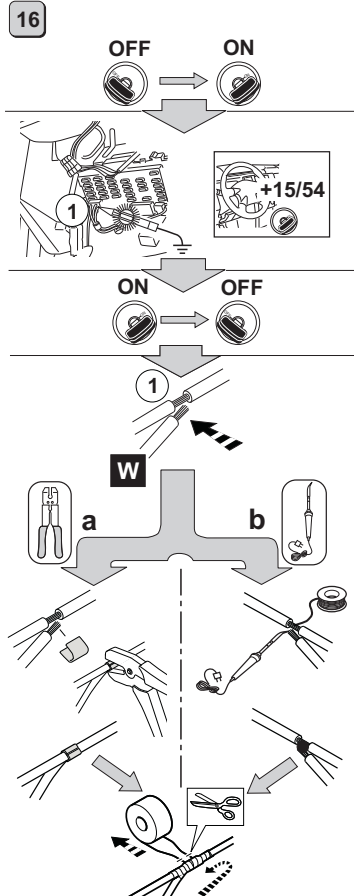

17

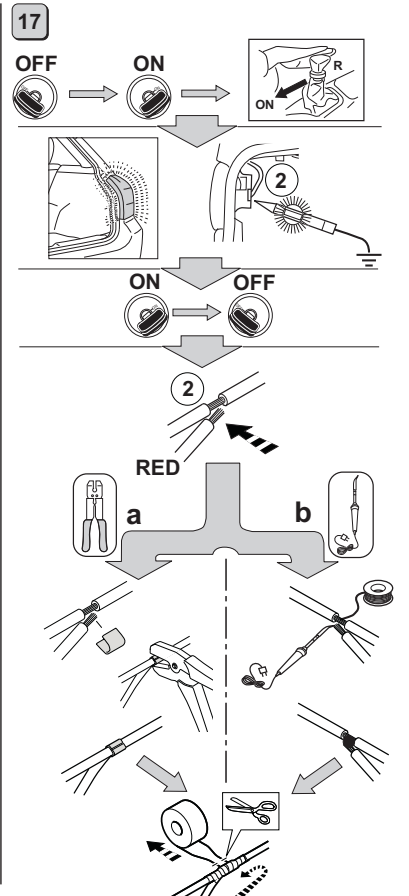

18

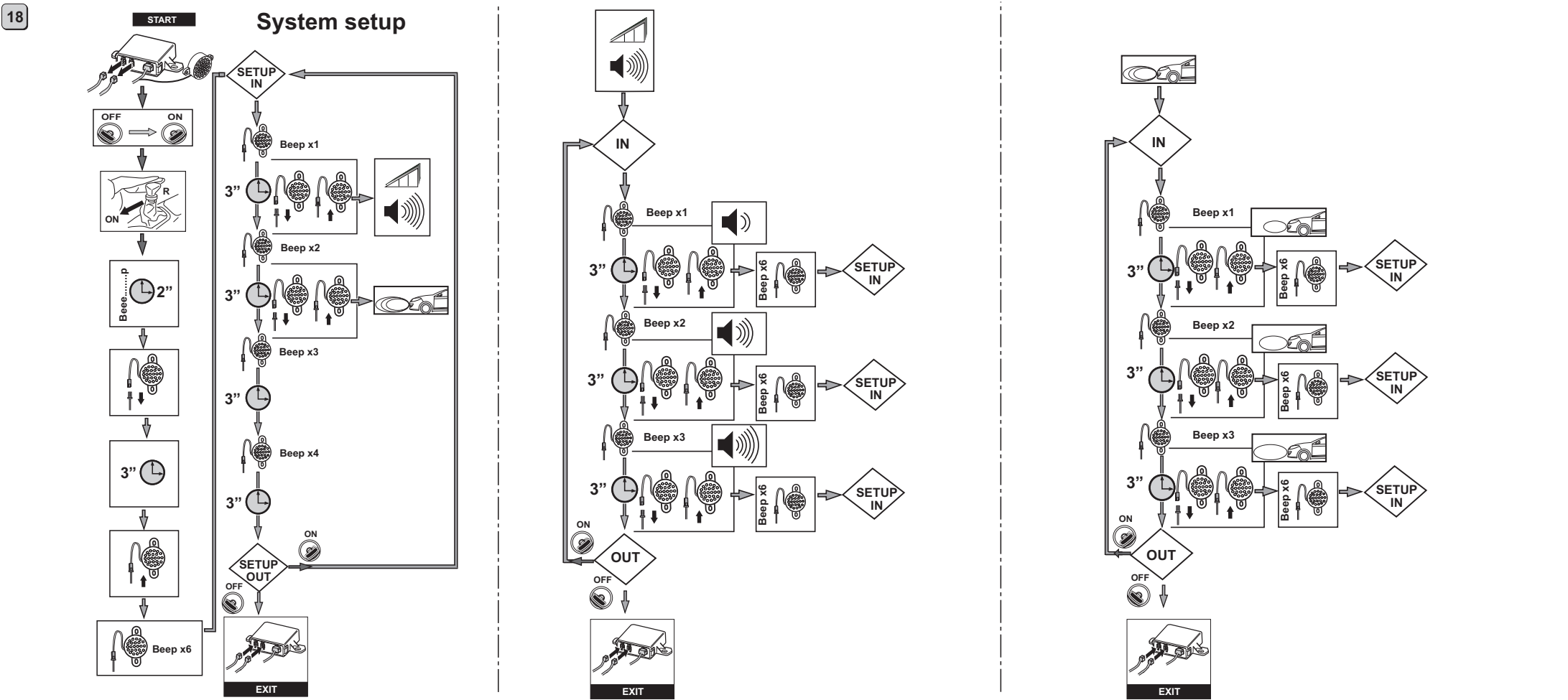

19

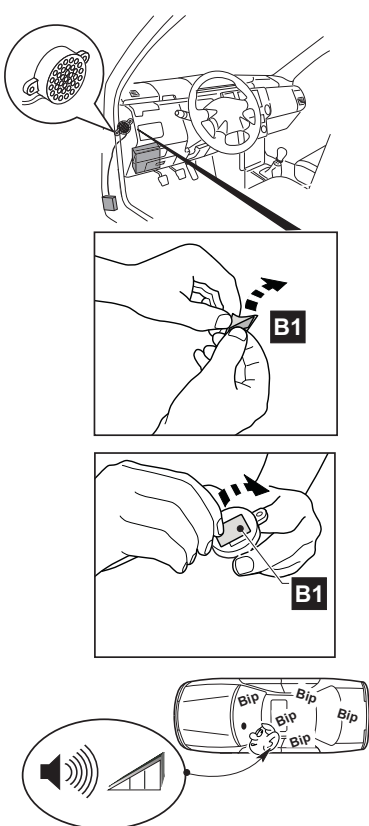

20 System functionality

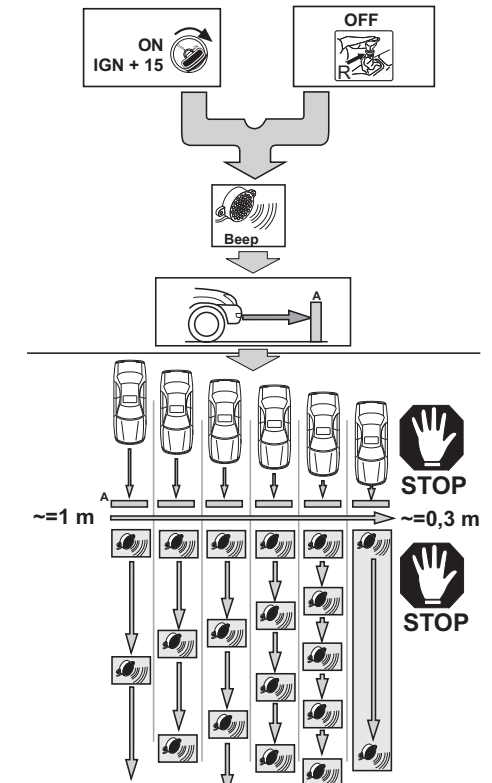

12 VDC.

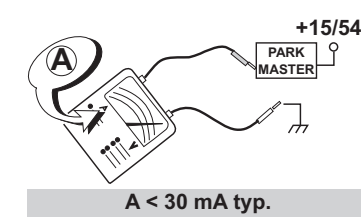

-40° C ÷ +85° C

ELECTRICAL/ELECTRONIC SUB-ASSEMBLY WAS APPROVED WITH REGARD TO E/CE/324-E/CE/TRANS/505 Add 9/Rev.3 Regulation No. 10 UNIFORM PROVISIONS CONCERNING THE APPROVAL OF VEHICLES WITH REGARD TO ELECTROMAGNETIC COMPATIBILITY.

Activation / Deactivation push button.  
Order: RV3608EUSAA  
(If not contained in the kit)

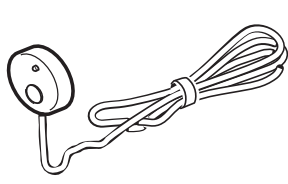

FOR ADDITIONAL FUNCTIONS SEE "INSTALLATION AND CONFIGURATION GUIDE" ON COBRA SITE.